



www.kidsflysafe.com



Instructional Safety Card

The following steps depict how to properly install and remove the CARES restraint. This restraint is not approved for use in any manner other than that depicted in these instructions.

Installation Limitations

The following paragraphs describe the installation limitations for the CARES restraint.

A. EMERGENCY EXIT ROW: This device may not be used in an emergency exit row or in any other location where a child is restricted from occupying the seat.

B. SEAT ORIENTATION: Use only in a forward-facing seat. Do not use this device in a side-facing seat.

C. OCCUPANT SIZE: The Type III child restraint is designed for use only by children who weigh 22-44 pounds (10-20 kilograms), whose height is 40 inches (101.6 centimeters) or less, and who can sit upright unassisted.

D. INFLATABLE RESTRAINTS: It is prohibited to install and use a child safety restraint behind any wall or seat back that has an inflatable airbag and on any seat that has an inflatable restraint system.

E. TRAY TABLES: On seats where the seat back's tray table is stowed flat against the sides of the seat back, install CARES under the tray table. On seats where the side of the seat back's tray table is stowed into a recessed area, install CARES over the tray table.

F. AUTOMOBILE USAGE: Do not use this device in an automobile. The CARES child restraint device has not been certified for use in automobiles.

G. THREE-POINT SHOULDER STRAP RESTRAINT: Use only the airplane passenger seat

lap-belt to attach this child restraint. This child restraint is not designed to be used with a shoulder strap or any other tether strap attached to the seat or airplane.

H. The conditions and test required by FAA letter dated December 19, 2005, "CRS Requirements," are minimum-standard performance standards.

I. Check with your carrier for additional requirements. Airline instructions/restrictions may vary.

J. GENERAL AVIATION: While the use of the CARES restraint in the pilot/co-pilot seat is not prohibited by FAA regulations, it is not recommended that this device be installed in such seat locations. It is recommended that the CARES restraint be installed on a non-pilot/non-co-pilot seat next to an adult that is capable of assisting the child as needed.

WARNINGS

DEATH OR SERIOUS INJURY MAY OCCUR if this restraint is not installed properly. Use only in a forward-facing seat. Attach this child restraint with the passenger seat lap-belt. Adjust this child restraint's belts snugly around your child. Follow ALL instructions on this child restraint and in the manufacturer's written instructions.

The CARES restraint may be carried on board an aircraft and installed by the passenger according to the amended operating rules under Title 14 CFR 91.107, §121.311, §125.211 and §135.128.

For information on traveling safely with children, go to the "Flying with Children" section of "Travelers" at www.faa.gov, or visit www.kidsflysafe.com.



Instructions for most standard airplane seats

On seats where the tray table is stowed flat against the seat back (not recessed), as shown in Figure 1, the CARES restraint must be installed under the tray table and can be used for the duration of the flight.

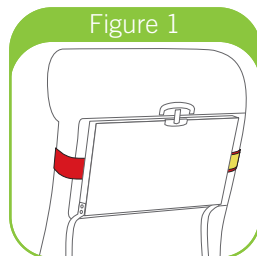

Figure 1



Step 1



Step 2



Step 3



Step 4



Step 5

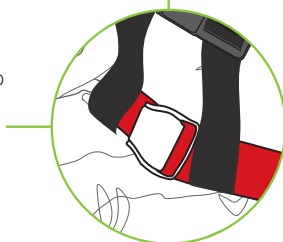

It is acceptable for the buckle to end up at one side instead of between the shoulder straps of the CARES airplane safety harness.

Removal Instructions

To free your child from the CARES restraint, release the lap-belt buckle, as shown in Step 6, and then slide the buckle and connector out of the black loops. Release the chest clip, as shown in Step 7, and allow your child to exit the seat.



Step 7

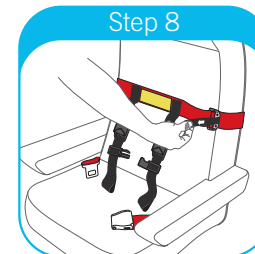

Step 8



Step 6

Emergency Removal Instructions

In an emergency, you can release the lap-belt and then pull the shoulder straps and chest clip over your child's head, as shown in Figure 2.

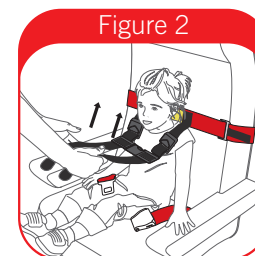

Figure 2

Instructions for select airplane seats

Seats with a recessed tray table – defined as a table that is stored in a cavity with rigid recessed sides. Install the CARES restraint's red loop over the stowed tray table, as shown in Figure 3.

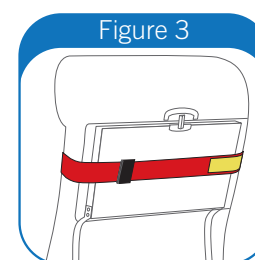

Figure 3



CARES conforms to US Patent Number 6,402,251.
©2013 Kids Fly Safe. CARES and the Kids Fly Safe Logo are trademarks of AmSafe, Inc. All rights reserved.
www.kidsflysafe.com